



Please dispose of packaging for the product in a responsible manner. It is suitable for recycling. Help to protect the environment, take the packaging to the local amenity tip and place into the appropriate recycling bin.

30 Ton Shop Press *(Pneumatic/Hydraulic)*



03695

**FOR HELP OR ADVICE ON THIS PRODUCT PLEASE CONTACT YOUR DISTRIBUTOR,
OR SIP DIRECTLY ON:
TEL: 01509500400
EMAIL: sales@sip-group.com or technical@sip-group.com
www.sip-group.com**

***Please read and fully understand the instructions in this manual
before operation. Keep this manual safe for future reference.***

DECLARATION OF CONFORMITY

Declaration of Conformity

We

SIP (Industrial Products) Ltd
Gelders Hall Road
Shepshed
Loughborough
Leicestershire
LE12 9NH
England

As the manufacturer's authorised representative within the EC
declare that the

30 Ton Shop Press (Pneumatic/Hydraulic) - SIP Part. No. 03695

Conforms to the requirements of the following directive(s), as indicated.

2006/42/EC Machinery Directive

And the relevant standard(s), including:

EN ISO 12100:2010
EN 1494:2000+A1:2008

Signed: 

Mr P. Ippaso - Managing Director - SIP (Industrial Products) Ltd
Date: 20/01/2015.



Page No.	Description
4.	Safety Symbols Used Throughout This Manual
4.	Safety Instructions
6.	Guarantee
7.	Contents and Accessories
8.	Technical Specifications
9.	Getting to Know Your Shop Press
10.	Assembly Instructions
12.	Operating Instructions
13.	Maintenance
14.	Troubleshooting
15.	Exploded Diagram
16.	Parts List
19.	Declaration of Conformity

SAFETY SYMBOLS USED THROUGHOUT THIS MANUAL



Danger / Caution: Indicates risk of personal injury and/or the possibility of damage.



Note: Supplementary information.

SAFETY INSTRUCTIONS



IMPORTANT: Please read the following instructions carefully, *failure to do so could lead to serious personal injury and / or damage to the Shop Press.*

When using your Shop Press, basic safety precautions should always be followed to reduce the risk of personal injury and / or damage to the Shop Press or load.

Read all of these instructions before operating the Shop Press and save this user manual for future reference.

The Shop Press should **not** be modified or used for any application other than that for which it was designed.

It was designed for the removal or installation of bearings, universal joints, pulleys, etc.

If you are unsure of its relative applications do not hesitate to contact us and we will be more than happy to advise you.

Before operating the Shop Press always check no parts are broken, that no oil is leaking and that no parts are missing.

Always operate the Shop Press safely and correctly.

KNOW YOUR SHOP PRESS: Read and understand the owner's manual and labels affixed to the Shop Press. Learn its applications and limitations, as well as the potential hazards specific to it.

KEEP CHILDREN AND UNTRAINED PERSONNEL AWAY FROM THE WORK AREA: All visitors should be kept at a safe distance from the work area; never allow untrained persons to operate the Shop Press.

STAY ALERT: Always watch what you are doing and use common sense.

NEVER LEAVE THE SHOP PRESS UNATTENDED: When in use / under load.

HAVE YOUR SHOP PRESS REPAIRED BY A QUALIFIED PERSON: The Shop Press is in accordance with the relevant safety requirements. Repairs should only be carried out by qualified persons using original spare parts, otherwise this may result in considerable danger to the user and void the warranty.

DANGER! Check that the shop press is in sound condition and good working order;

NOTES

PARTS LIST

Ref. No.	Description	SIP Part No.	Ref. No.	Description	SIP Part No.
1.	Frame	HY02-00170	21.	Hydraulic hose	HY02-00190
2.	Leg	HY02-00171	22.	O-ring	HY02-00191
3.	Support Bar	HY02-00172	23.	Connector	HY02-00192
4.	Bed	HY02-00173	24.	Bolt	HY02-00193
5.	Bed support pin clip	HY02-00174	25.	Lock Washer	HY02-00194
6.	Bed support pin	HY02-00175	26.	Washer	HY02-00195
7.	Bolt	HY02-00176	27.	Connector	HY02-00196
8.	Washer	HY02-00177	28.	Nut	HY02-00197
9.	Lock Washer	HY02-00178	29.	Screw	HY02-00198
10.	Nut	HY02-00179	30.	Manometer fitting	HY02-00199
11.	Bolt	HY02-00180	31.	Nylon washer	HY02-00200
12.	Spring	HY02-00181	32.	Manometer	HY02-00201
13.	Connector	HY02-00182	33.	Hydraulic hose	HY02-00202
14.	R-Pin	HY02-00183	34.	Pump assembly	HY02-00203
15.	Adjuster	HY02-00184	35.	Pump handle	HY02-00204
16.	Ram assembly	HY02-00185	36.	Pump handle cover	HY02-00205
17.	Screw	HY02-00186	41.	Arbor plate	HY02-00206
18.	Ram support plate	HY02-00187	N/A.	Air motor	HY02-00150
19.	Bolt	HY02-00188	N/A.	Air valve	HY02-00148
20.	Screw	HY02-00189	N/A.	Air hose	HY02-00149

SAFETY INSTRUCTIONS...cont

Take immediate action to repair or replace damaged parts.

WARNING! Only operate on a level and stable surface and never use on soft ground where the Shop Press is likely to “sink” whilst in operation.

NEVER STAND ON THE SHOP PRESS: The Shop Press is not designed for this purpose.

DO NOT dismantle or tamper with the Shop Press, as this may be dangerous and will invalidate the warranty.

- If a problem with the Shop Press is experienced or suspected stop using the Shop Press **immediately** and contact your distributor for repair.
- Do not attempt to press a load that exceeds the rated capacity of the Shop Press.
- Never work under the Shop Press whilst in operation.
- Regularly inspect, clean and lubricate the Shop Press, ensuring that it is in good working order and condition.
- Always ensure that the work area is clean and tidy, free from unrelated materials and has adequate lighting.
- Keep hands, limbs etc. clear of moving parts during operation of the ram.
- **DO NOT** top-up the Shop Press with brake fluid, or other oil types; use hydraulic oil only.
- **DO NOT** adjust the safety overload valves.
- Ensure that there are no persons or obstructions beneath the Shop Press whilst its in operation.
- Clean the Shop Press correctly, with the ram in the down position, but **DO NOT** leave it extended.
- Failure to follow the warnings in this manual, may result in personal injury and/or property damage.
- Prior to applying the load, be sure that the hydraulic ram collar threads are fully engaged to the head assembly.
- Components of this Shop Press are specially designed to withstand the rated capacity. Do not substitute bolts, pins, or any other components.
- Always press the load on the centre of the ram. Offset loads can damage the ram, and may cause a workpiece to eject.
- Before operating, check for signs of cracked welds, bent bed support pins, loose or missing bolts, or any other structural damage. Do not operate if any of these conditions exist. Have repairs made only by authorised service centre.
- Remove all loads and arbor plates from the bed before attempting to adjust the bed height.
- Press only on the workpiece supported by the bed and arbor plates.
- When using accessories, such as arbor plates, be sure that they are centered on the bed, and are in full contact with the bed.
- Parts being pressed may splinter, shatter or eject from the press. Due to various applications, it is your responsibility to always use adequate guards, such as eye protection and heavy protective clothing, when operating this Shop Press.
- Do not stand in front of work area where the load is applied.

SAFETY INSTRUCTIONS....cont

- If the Shop Press appears to be damaged in any way, is found to be badly worn, or operates abnormally **IT SHOULD BE REMOVED FROM SERVICE** until necessary repairs are made by an authorised service centre.
- **DO NOT** use the Shop Press to compress springs or any other item that could disengage and cause a potential hazard.
- Understand the operating environment; Before each use the operator should assess, understand and where possible reduce the specific risks and dangers associated with the operating environment. Bystanders should also be made aware of any risks associated with the operating environment.



Danger / Caution: Never exceed the maximum capacity of 30 ton, over-loading can lead to personal injury or damage to the Shop Press.



CAUTION: The warnings and cautions mentioned in this user manual can not cover all possible conditions and situations that may occur. It must be understood by the operator that common sense and caution are factors which cannot be built into this product, but must be applied.

GUARANTEE

This SIP Shop Press is covered by a 12 month parts and labour warranty covering failure due to manufacturers defects. This does not cover failure due to misuse or operating the Shop Press outside the scope of this manual - any claims deemed to be outside the scope of the warranty may be subject to charges including, but not limited to parts, labour and carriage costs.

This guarantee does not cover consumables such as oil, arbor plates etc.

In the unlikely event of warranty claims, contact your distributor as soon as possible.



Note: Proof of purchase will be required before any warranty can be honoured.

EXPLODED DIAGRAM

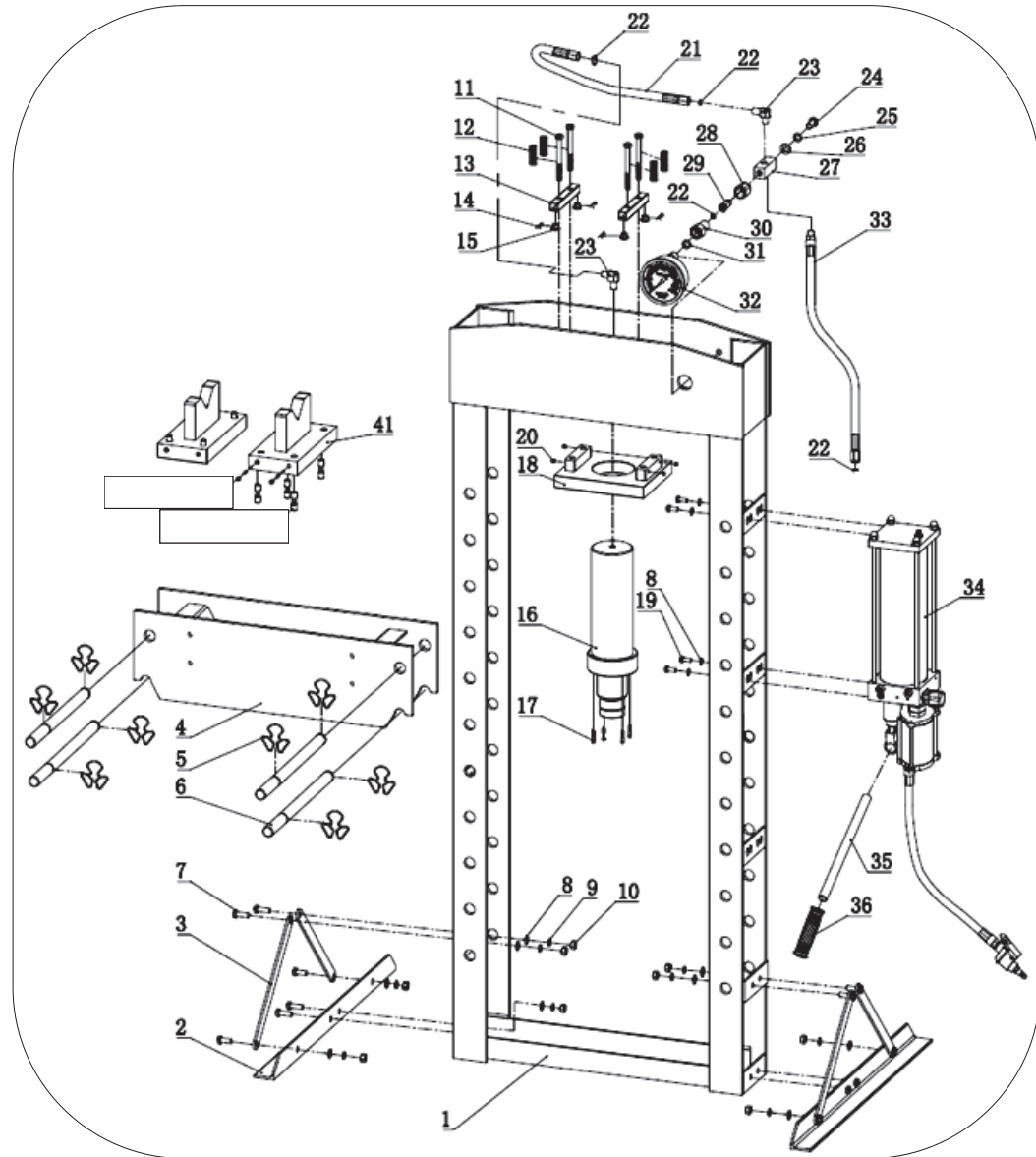

TROUBLESHOOTING

The following form lists the common operating issues with problems and solutions. Please read the form carefully and follow it.



If any of the following symptoms occurs during your operation, stop using the Shop Press immediately, or serious personal injury could result. Only a qualified person or an authorised service centre should perform repairs on the Shop Press. Disconnect from the air supply before attempting repairs or adjustments. When replacing parts etc.

FAULT	POSSIBLE CAUSES	POSSIBLE REMEDIES
Loses pressure under load.	<ul style="list-style-type: none"> Release valve is open. Pump or piston fault. 	<ul style="list-style-type: none"> Close release valve. Replace pump.
Pump feels spongy during pumping, or lever has lost stroke.	<ul style="list-style-type: none"> Pump low on oil. Air trapped in pump. Pump or ram fault. 	<ul style="list-style-type: none"> Top up with oil. Bleed air out of system. Replace pump/ram.
Ram is weak or does not reach rated pressing capacity.	<ul style="list-style-type: none"> Pump low on oil. Air trapped in pump. Release valve is open. Pump or piston fault. 	<ul style="list-style-type: none"> Top up with oil. Bleed air out of system. Close release valve. Replace pump.



Note: Repairs should be carried out by a qualified person.

CONTENTS & ACCESSORIES

1. Hydraulic Pump	7. Bed	N/A. M10 x 20 Bolt (x4)
2. Arbor plate (x2)	8. Bed Pin (x4)	N/A. 10mm Washer (x16)
3. Manometer	9. Bed Pin Clip (x8)	N/A. 10mm Spring Washer (x12)
4. Leg (x2)	N/A. Frame (c/w ram)	N/A. Nut M10 (x12)
5. Leg Support (x4)	N/A. Instruction Manual	
6. Pump Handle	N/A. M10 x 35 Bolt (x12)	

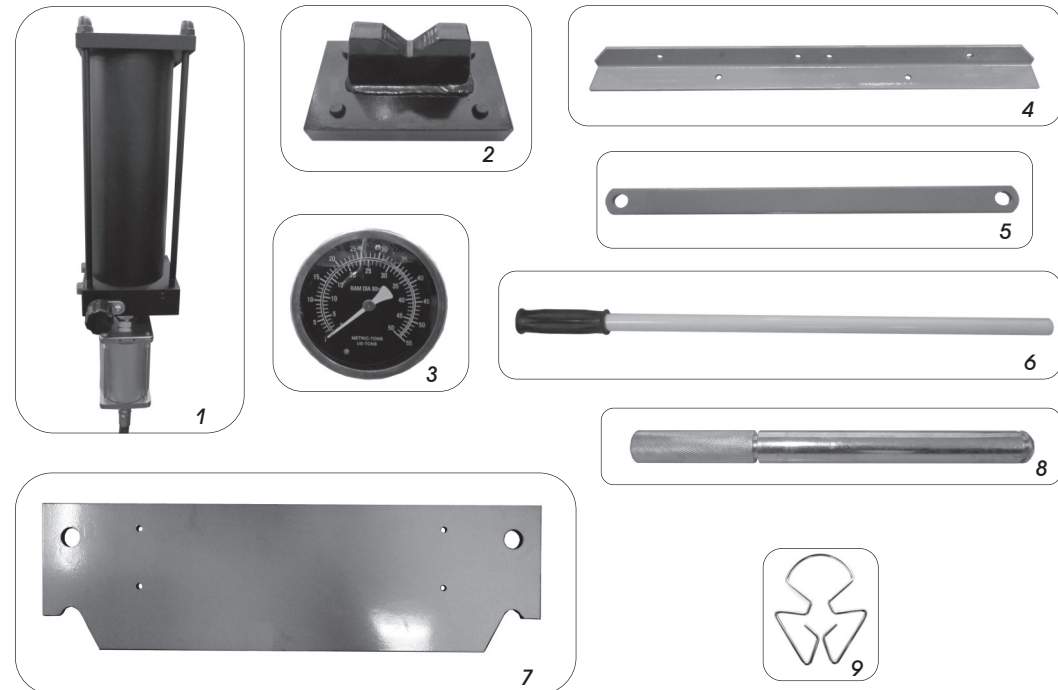

Note: If any of the above are missing or damaged, contact your distributor immediately.

TECHNICAL SPECIFICATIONS

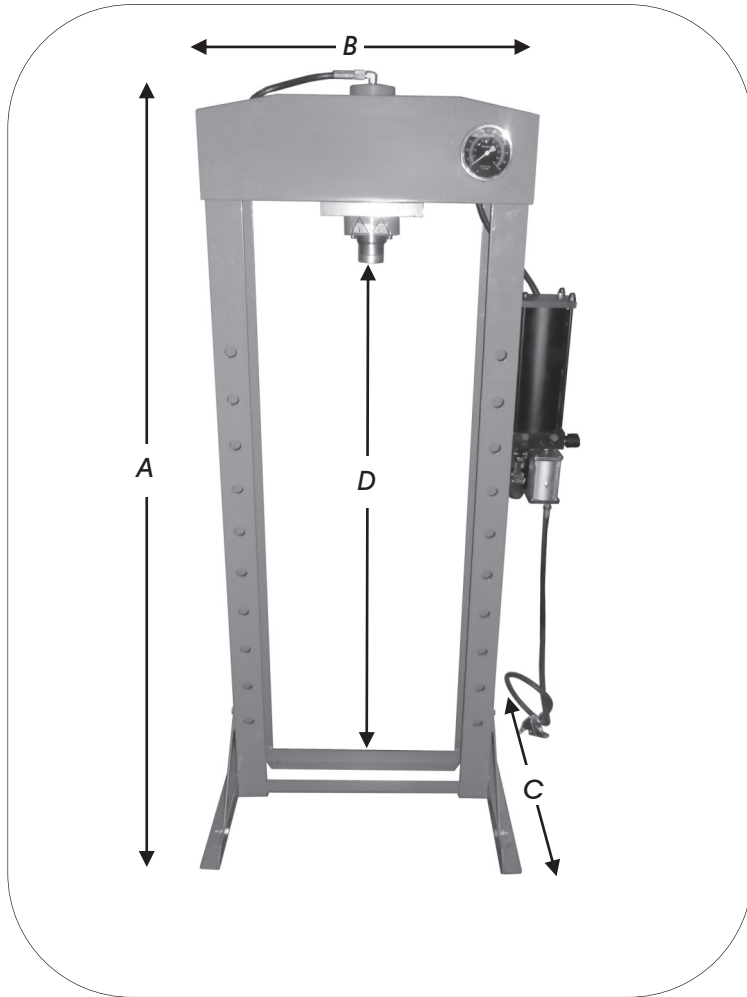

Height (A)	1830mm
Width (B)	915mm
Depth (C)	700mm
Working range (D)	151 - 1031mm
Ram Stroke	150mm
Bed Width	535mm
Operating Air Pressure	7 - 8 Bar

OPERATING INSTRUCTIONS...cont

- ⇒ Once the work is done release the air valve lever (or stop pumping the handle).
- ⇒ Turn the release valve anti-clockwise to retract the ram.
- ⇒ When the ram has fully retracted, remove the workpiece.
- ⇒ If no more work is to be done, then disconnect from the air supply and retighten the release valve and air vent / oil fill screw.

MAINTENANCE

- ⇒ Periodically check the press frame to make sure all bolts are tight and inspect for cracked welds, bent, loose, or missing parts.
- ⇒ Periodically check hydraulic connections for possible leaks, replace or properly repair damaged or leaking hydraulic components before use.
- ⇒ Change hydraulic oil in the hydraulic system every 100 working hours, or more frequently in unusual dirty or dusty areas.
- ⇒ If the paint becomes badly chipped, it is suggested to repaint the press. This will prevent rusting.

ADDING OIL

- ⇒ Make sure the ram is fully retracted.
- ⇒ Remove the air vent / oil fill screw.
- ⇒ Fill with hydraulic oil (#22 ISO6743) through the oil fill hole, until the oil reaches the top of the oil chamber.
- ⇒ Refit the air vent / oil fill screw.

BLEEDING

- ⇒ Loosen the air vent / oil fill screw.
- ⇒ Insert the handle into the handle base.
- ⇒ Pump the handle about 10 times, this will purge the air out of the system.
- ⇒ retighten the air screw.

CLEANING

Periodically check the ram and ram piston for signs of rust or corrosion. Clean as needed and wipe with an oily cloth.



Note: Never use sandpaper or abrasive material on these surfaces.

OPERATING INSTRUCTIONS

- ⇒ Place the bed to your desired height, use the bed support pin (x4) and bed support pin clips (x8) to secure in place.
- ⇒ Place the arbor plate on the bed, then place the workpiece onto the arbor plate.



Danger / Caution: At all times use all 8 bed support pin clips to secure the bed support pins, using without the bed support pin clips is dangerous, this could cause injury to you or any one in the vicinity, this will also damage the Shop Press and void your warranty.

- ⇒ Turn the release valve clockwise to close it (007).

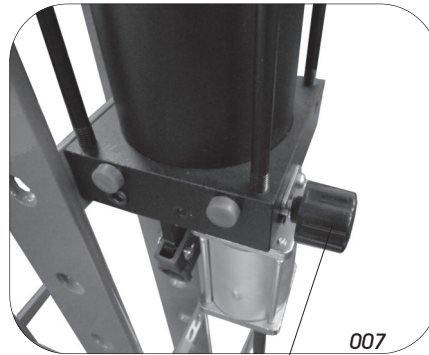

Release valve

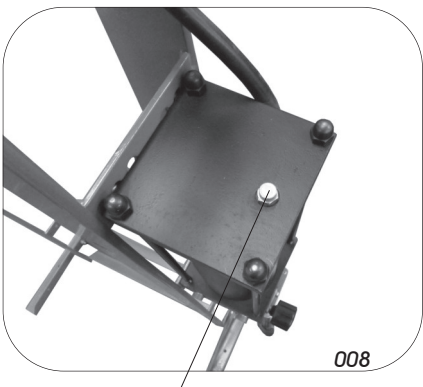

- ⇒ Open the air vent / oil fill screw on the hydraulic pump (008).

Air vent / oil fill screw

- ⇒ Connect the air supply to the air valve inlet connection, press the air valve lever down and the ram will start too move (use the pump handle if no air supply is available), once the serrated saddle is near the workpiece take your hand off the air valve lever (or stop pumping the handle).
- ⇒ Align the workpiece and ram to ensure centre loading.
- ⇒ Press the air valve lever down again (or pump the handle) to start the pressing.

GETTING TO KNOW YOUR SHOP PRESS

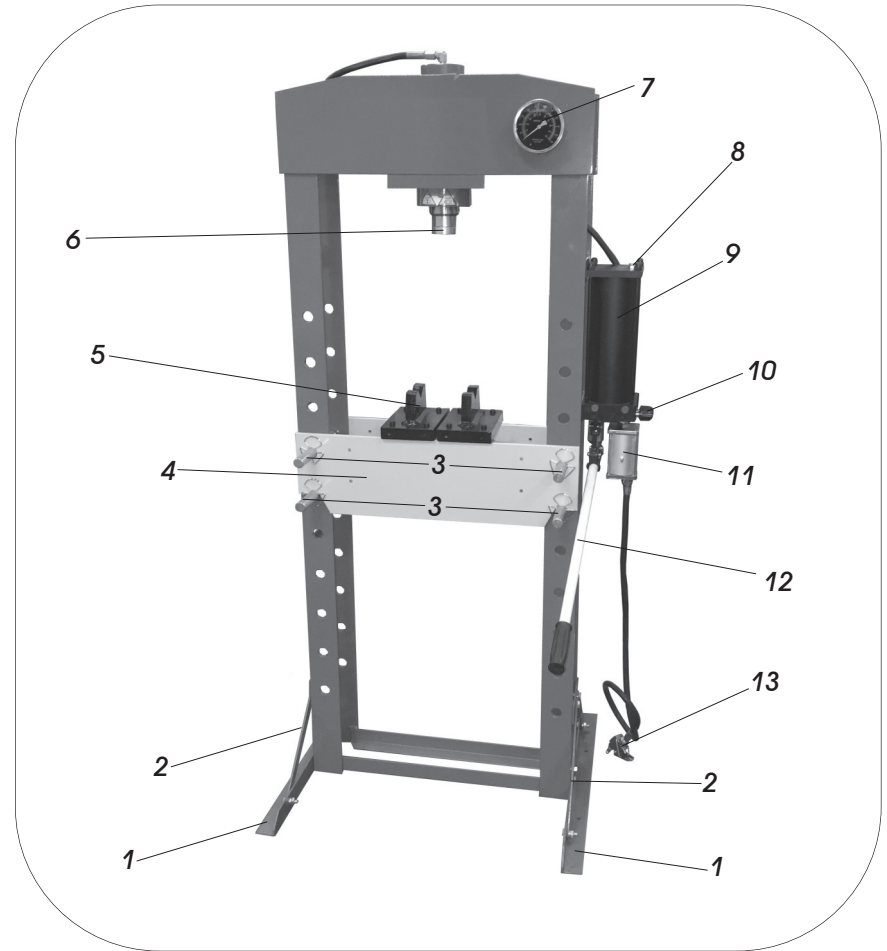

Ref. No	Description	Ref. No	Description
1.	Leg	8.	Air Vent / Oil Filler Screw
2.	Leg Supports	9.	Hydraulic Pump
3.	Bed Pin	10.	Release Valve
4.	Bed	11.	Air Motor
5.	Arbor Plate	12.	Pump Handle
6.	Hydraulic Ram	13.	Air Valve
7.	Manometer		

ASSEMBLY INSTRUCTIONS

FITTING THE LEGS

- ⇒ Connect the leg to either the left or right post by using the M10x35 bolt (x2), 10mm washer (x2), 10mm spring washer (x2) and M10 nuts (x2), do not tighten fully just yet (001).

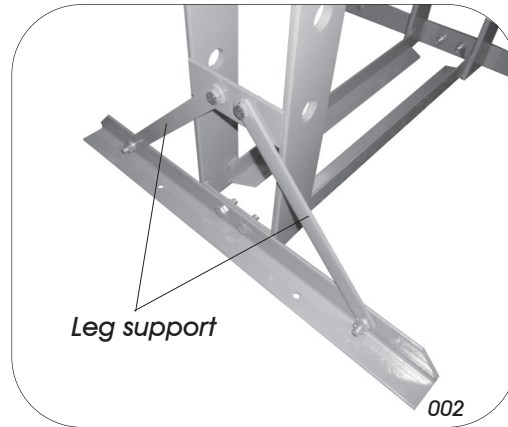
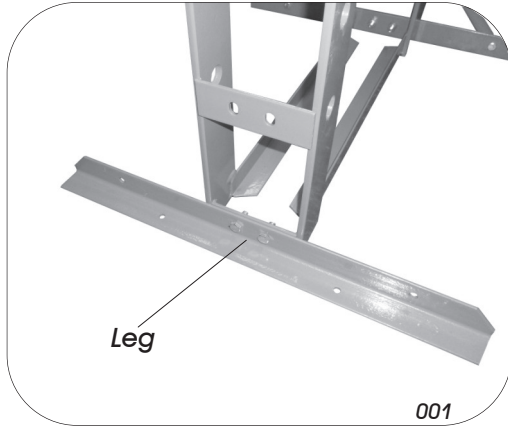

- ⇒ Connect both leg supports to the post and leg, by using M10x35 bolt (x4), 10mm washer (x4), 10mm spring washer (x4) and M10 nuts (x4) (002).
- ⇒ Repeat the process for the other post.
- ⇒ Make sure everything is level, then proceed to tighten all the bolts.

FITTING THE HYDRAULIC PUMP

- ⇒ Bolt the hydraulic pump to the side of the frame, by using M10x20 bolt (x4) & 10mm washer (x4) (003).

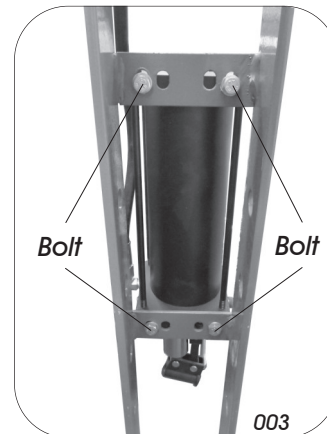

ASSEMBLY INSTRUCTIONS...cont

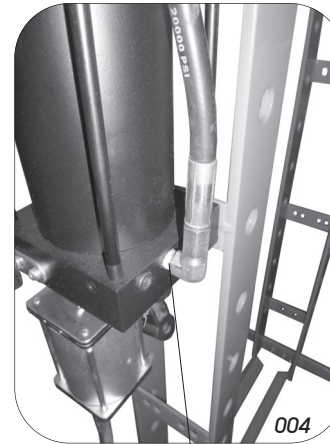

- ⇒ Connect the hydraulic hose onto the lower fitting on the ram (004).

Lower fitting

- ⇒ Connect the other side of the hydraulic hose to the manometer fitting, located inside the frame at the top (005).

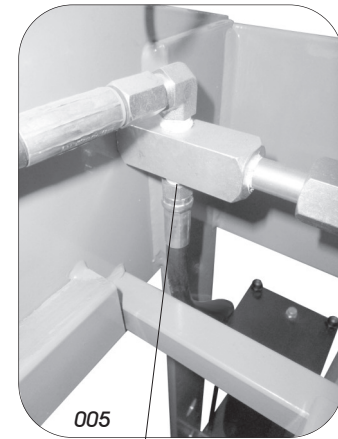

Upper fitting

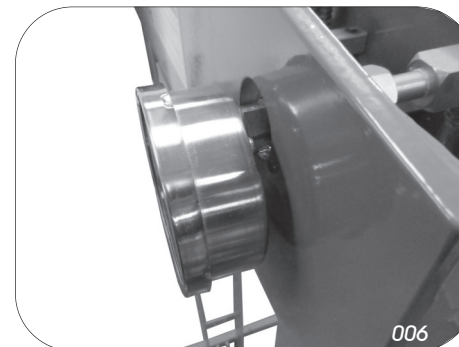

- ⇒ Lastly screw the manometer in to the manometer fitting (006).